

SERVICE PARTS

EXPLODED VIEW
for J180 4" Hinge & PAD Mount







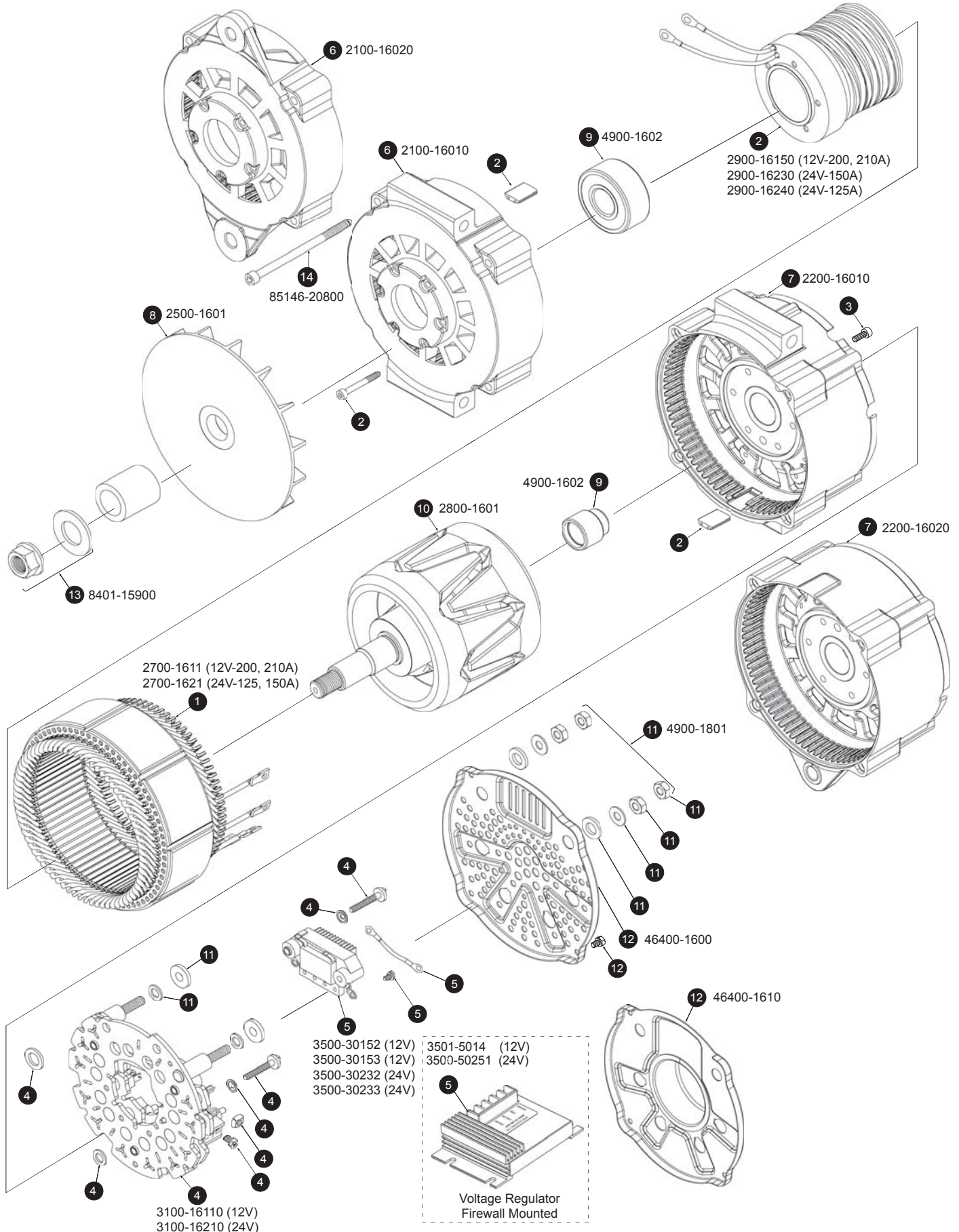

Series 161

9800-DELS-161
160519

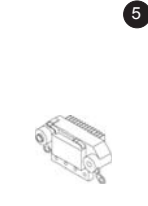
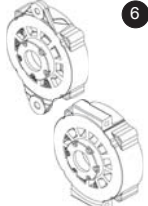

MAJOR COMPONENTS

							
MODEL No.	V-Amp @ 2000 / 5000 RPM	STATOR ASSY.	COIL PKG.	RECTIFIER PKG.	REGULATOR OR TERM. BLOCK	FRONT HOUSING ASSY. <small>Includes Bearing</small>	REAR HOUSING ASSY. <small>Includes Bearing</small>

100-16100	12V 116 / 200A	2700-1611	2900-16150	3100-16110	3500-30152 3500-30153	2100-16020	2200-16020
100-16104	12V 115 / 210A	2700-1611	2900-16150	3100-16110	46800-300 *	2100-16020	2200-16020
100-16105	12V 116 / 200A	2700-1611	2900-16150	3100-16110	3500-30152 3500-30153	2100-16020	2200-16020
100-16110	12V 116 / 200A	2700-1611	2900-16150	3100-16110	3500-30152 3500-30153	2100-16010	2200-16010
100-16115	12V 116 / 200A	2700-1611	2900-16150	3100-16110	3500-30152 3500-30153	2100-16010	2200-16010

100-16202	24V 55 / 150A	2700-1621	2900-16230	3100-16210	46800-300 *	2100-16020	2200-16020
100-16204	24V 54 / 125A	2700-1621	2900-16240	3100-16210	3500-30232 3500-30233	2100-16020	2200-16020
100-16205	24V 55 / 150A	2700-1621	2900-16230	3100-16210	3500-30232 3500-30233	2100-16020	2200-16020
100-16214	24V 54 / 125A	2700-1621	2900-16240	3100-16210	3500-30232 3500-30233	2100-16010	2200-16010
100-16215	24V 55 / 150A	2700-1621	2900-16230	3100-16210	3500-30232 3500-30233	2100-16010	2200-16010

* Terminal block connector pkg. For firewall mounted voltage regulator use **3501-5014** (12V) or **3500-50251** (24V)

COMPONENTS LISTING

ITEM	PART No.	DESCRIPTION
1	2700-1611	STATOR ASSY., 161 (12V-200, 210A)
1	2700-1621	STATOR ASSY., 161 (24V-125, 150A)
2	2900-16150	COIL PKG., 161 Single (12V-200, 210A)
2	2900-16230	COIL PKG., 161 Single (24V-150A)
2	2900-16240	COIL PKG., 161 Single (24V-125A)
4	3100-16110	RECTIFIER PKG. 160, 161 (12V)
4	3100-16210	RECTIFIER PKG. 160, 161 (24V)
5	3500-30152	V. REGULATOR PKG., 14.2 V. Set
5	3500-30153	V. REGULATOR PKG., 14.2 V. Set (Adjustable)
5	3500-30232	V. REGULATOR PKG., 28.0 V. Set
5	3500-30233	V. REGULATOR PKG., 28.0 V. Set (Adjustable)
5	3501-5014	V. REGULATOR, 14.2 V. Set (Adjustable) Firewall Mounted
5	3500-50251	V. REGULATOR, 28.0 V. Set (Adjustable) Firewall Mounted

ITEM	PART No.	DESCRIPTION
6	2100-16010	HOUSING ASSY. 160, 161 Front, PAD
6	2100-16020	HOUSING ASSY. 160, 161 Front, J180
7	2200-16010	HOUSING ASSY. 161 Rear, PAD
7	2200-16020	HOUSING ASSY. 161 Rear, J180
8	2500-1601	FAN, 160 (Directional CW)
9	4900-1602	BEARING KIT 160, 161 Series
10	2800-1601	ROTOR ASSY., 161 Series (Single rotor)
11	4900-1801	HARDWARE PKG.
12	46400-1600	COVER PLATE PKG. 160, 161
12	46400-1610	COVER PLATE PKG. 160, 161 with 2.00" Ø air intake
13	8401-15900	PULLEY NUT PKG., (5/8-18 Thread)
14	85146-20800	THRU-BOLT PKG. (M6 X 1.0 X 80mm L)

Corporate Headquarters Manufacturing and Distribution

Dixie Electric Ltd.
517 Basaltic Road
Concord, ON. Canada L4K 4W8
Tel.: 905-879-0533 Fax: 905-879-0532
U.S. 800-563-3933
E-Mail: sales@dixie-electric.com
Web Site: www.dixie-electric.com



USA Sales and Distribution

Dixie Electric Inc.
17100 Medina Road, Suite 100
Minneapolis, MN. U.S.A. 55447-1249
Tel.: 763-475-6629 800-478-0608
Fax: 763-475-6635 800-392-8719
E-Mail: mn.sales@dixie-electric.com
Web Site: www.dixie-electric.com